

# OVER-THE-FRYER CRUMB DUMP: INSTALLATION INSTRUCTIONS

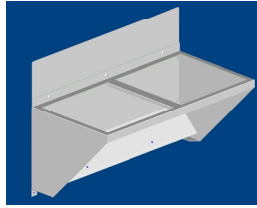

## Over-The-Fryer Crumb Dump Mounting Procedure

Remove existing top screws (2) from back of fryer flue (**A**).

Place the crumb dump assembly on top of fryer flue. (NOTE: The crumb dump back panel should be on top of the flue deflector). Secure the crumb dump to the flue deflector with screws and locknuts provided (**B**).

Replace sheet metal screws on the back of flue (**A**).

